



Valve Regulated Lead Acid Battery

Maintenance-Free Sealed Lead Acid Battery.

Absorbent Glass Mat (AGM) technology for efficient gas recombination of up to 99%.

Design for Standby Power Applications

【Design Life】

Up to 20 Years in Standby Service at 25°C
Eurobat (20°C) : 12 years and longer, Long Life

【Operating Temperature Range】

Nominal Operating Temperature : 25°C (77°F)
Discharge : -20°C ~ 50°C (-4°F~122°F)
Charge: 0°C ~ 40°C (32°F~104°F)
Storage: -20°C ~ 40°C (-4°F~104°F)

【Float Charging Voltage】

2.21 ~ 2.25 VDC/Unit at 25°C (77°F)

【Equalization Charging Voltage】

2.35 VDC/Unit at 25°C (77°F)

【Self Discharge】

Less than 10% after 90 days, can be stored up to 6 months at 25°C (77°F);
Fully recharging is required before usage, and charged sooner if stored at higher temperature than 25°C (77°F).

Specification

Nominal Voltage	2V (single cell per unit)	
Nominal Capacity	650 Ah @10hr-rate to 1.80V per cell @25°C (77°F)	
Weight	Approx. 46.60 Kg (102.71 lbs)	
Maximum Discharge Current	3900 A (5sec)	
Internal Resistance	Approx. 0.26 mΩ	
Short Circuit Current	13235A	
Maximum Charge Current	195 A	
Terminal type	I4 thread copper alloy terminal to accept M8 bolt	
Terminal tightening torque	126±25 Kgf·cm / 109±22 Lbf·in / 12.3±2.5 N·m	
Container Material	Flame Retardant ABS (UL 94-V0)	
Dimensions	Depth (D)	307.0±2.5 mm 12.09±0.10 inch
	Width (W)	171.0±2.0 mm 6.73±0.08 inch
	Container height (h)	331.0±2.5 mm 13.03±0.10 inch
	Overall Height (H)	339.0±2.5 mm 13.15±0.10 inch

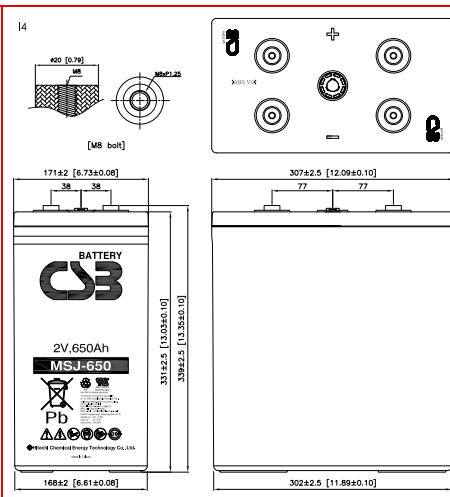

Constant Current Discharge Characteristics Unit: A (25°C, 77°F)

F.V/Time	15MIN	30MIN	60MIN	2HR	3HR	4HR	5HR	6HR	8HR	10HR	20HR	24HR
1.60V	1205	807	494	283	203	157	128	108	84.6	70.0	35.0	29.2
1.67V	1079	767	481	279	201	155	127	107	83.9	69.5	34.7	28.9
1.70V	1014	741	472	277	199	154	126	106	83.5	69.1	34.6	28.8
1.75V	912	675	449	271	196	151	124	105	82.3	68.2	34.1	28.4
1.80V	780	597	414	259	189	146	120	102	80.1	66.5	33.2	27.7
1.83V	690	548	388	248	181	141	116	99.0	77.9	64.6	32.3	26.9

Constant Power Discharge Characteristics Unit: W (25°C, 77°F)

F.V/Time	15MIN	30MIN	60MIN	2HR	3HR	4HR	5HR	6HR	8HR	10HR	20HR	24HR
1.60V	2109	1463	898	540	387	305	254	217	167	130	65.2	54.3
1.67V	1960	1407	881	535	384	303	252	216	165	129	64.7	53.9
1.70V	1883	1371	867	531	382	302	251	215	164	128	64.0	53.3
1.75V	1721	1281	832	520	375	298	248	213	162	127	63.5	52.9
1.80V	1543	1157	776	500	363	290	242	207	157	123	61.7	51.4
1.83V	1391	1079	732	480	351	282	235	202	152	120	59.8	49.8

Please refer to the official site for the latest rating confirmation. URL: www.csb-battery.com

Issued: 200218

Sales Offices

日立化成能源科技股份有限公司
Hitachi Chemical Energy Technology Co., Ltd.

Recognized under UL 1989,
and certified by ISO 9001, 14001.



BUSINESS HEADQUARTERS

Tel: +886-2-2880-5600
Fax: +886-2-2888-3300

USA OFFICE

Tel: +1-817-244-7777 / 1-(800)3-CSB-USA (272872)
Fax: +1-817-244-4445

SHENZHEN OFFICE (CHINA)

Tel: +86-755-8831-6488, 8831-6775
Fax: +86-755-8831-6075

EUROPE (EMEA) OFFICE

Tel: +31(0)180-418-140
Fax: +31(0)180-418-327

SHANGHAI OFFICE (CHINA)

Tel: +86-21-5046-1622, 5046-0833
Fax: +86-21-5046-1046

TAIPEI OFFICE

Tel: +886-2-2880-5600
Fax: +886-2-2888-3300

BEIJING OFFICE (CHINA)

Tel: +86-10-5820-5336, 5820-5338
Fax: +86-10-5820-3053